

# Inhalt

1 Befestigungsleiste,  
selbstklebend  
innen und außen



1 Klettband, selbstklebend



1 Fluschband

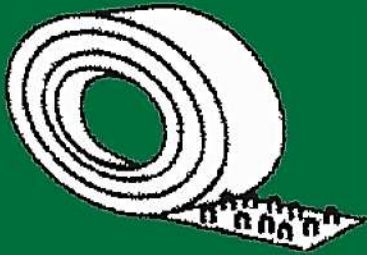

4 randverstärkte  
Polylamellen  
mit eingenähten Gewichten

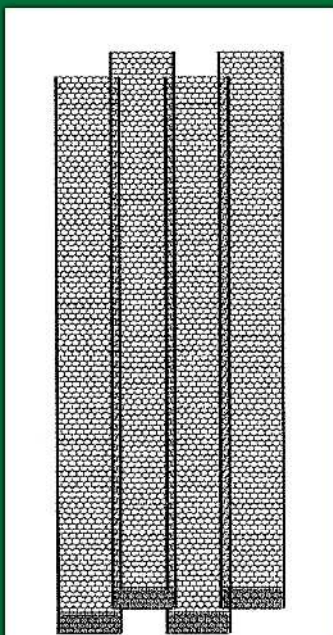

# Dauerhafte Montage



1. Rahmen reinigen

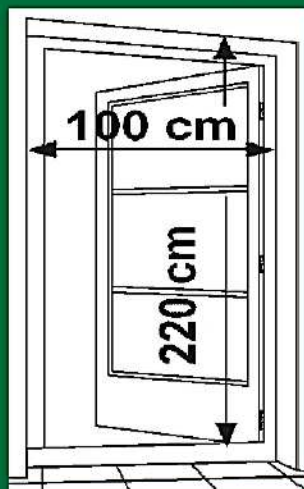

2. Türbreite messen

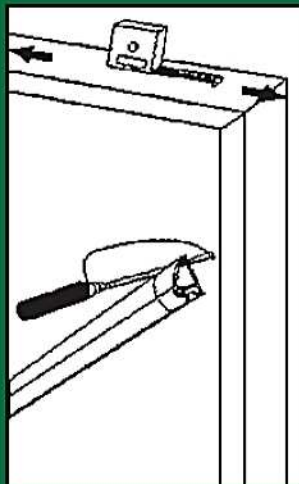

3. Klemmleiste absägen

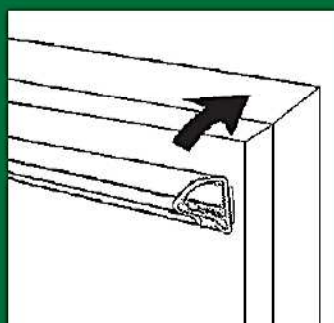

4. Klemmleiste ankleben

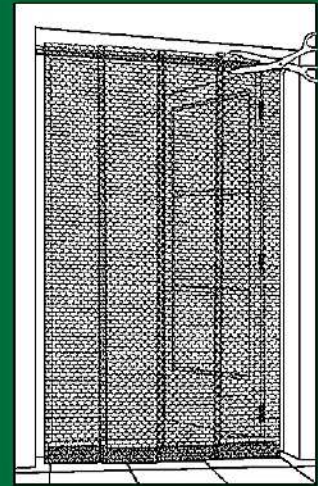

5. Lamellen kürzen

# Abnehmbare Montage

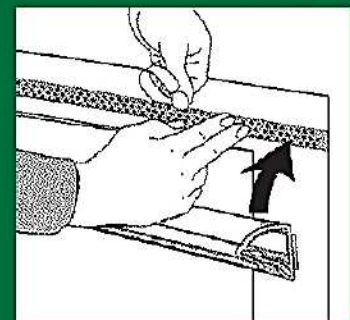

1. Klettband an Türrahmen  
kleben